

From JR Kamegawa Station

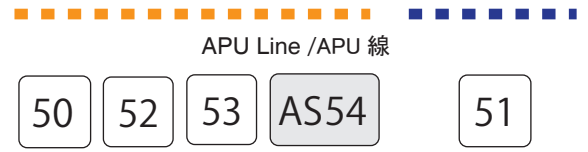

Oita Kotsu Bus 大分交通



From the JR Kamegawa Station:
Take Oita Kotsu bus bound for APU
→ Get off at Ritsumeikan Asia
Pacific University (APU)

Fare (One way): 340 yen
About 15 minutes

From Oita Airport

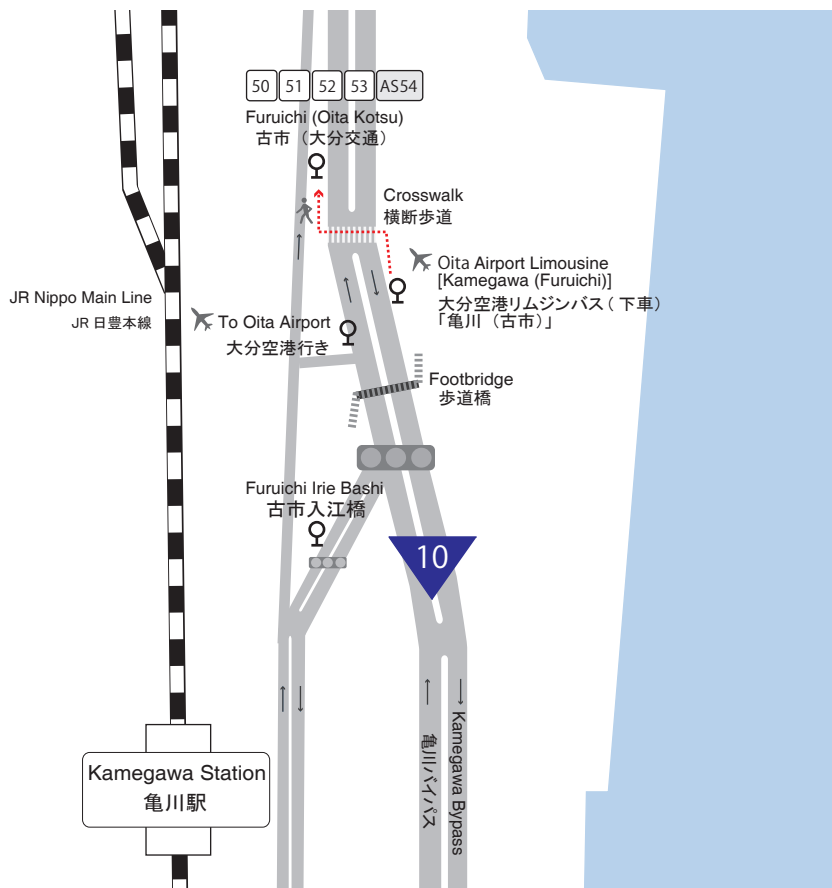

① From the Oita Airport:
Take Airport Airliner Limousine Bus →
Get off at Kamegawa (Furuichi) Bus
Stop

Fare (One way): 1,350 yen
About 35 minutes

② Across road from Kamegawa
(Furuichi) Bus Stop, transfer to Oita
Kotsu Bus bound for APU
→ Get off at Ritsumeikan Asia Pacific
University (APU)

Fare (One way): 340 yen
About 10 minutes